

# Trouble shooting

TJ325, TJ525 and TJ1000, Transmission jacks

---

## Transmission jack unable to lift maximum rated capacity

Thank you for contacting us and for letting us participate in resolving the problem.

If the transmission jack is unable to lift the rated capacity then please follow the steps below to resolve the problem.

### IMPORTANT:

Read the capacity label on the transmission jack to ensure that you know the exact maximum rated capacity. Never adjust the capacity of the transmission jack to lift more than the rated capacity.

1. Remove the parts as per # 1 on the illustration below.
2. Find the screw as per # 2 on the illustration below.
3. Turn the screw  $\frac{1}{2}$  a turn clockwise.
4. Assemble the parts again and check whether the transmission jack will lift to the maximum rated capacity.

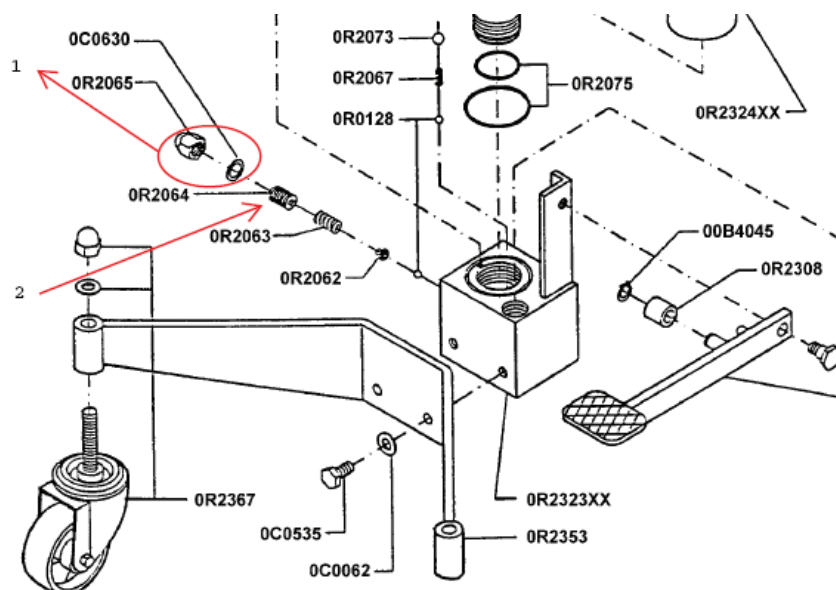

1.2. 2026 1/1-U1